

# NH DC 1100 V

Rated voltage	1100 d.c. (L/R = 5 ms)
Breaking capacity	25 kA d.c.
Standards	IEC 60269-2, IEC 60269-4
Application	Fuse-link for DC application. Applied in fuse base U1-3-1/1200/H.

Size	$I_n$ [A]	Standard indicator (pic. 1)	Code No. Trip indicator - K (pic. 2)	$S_{170}$ screw contact (pic. 3)	Power dissipation [W]	Pre-arcing joule integral (A <sup>2</sup> s) (L/R = 5ms)	Operating joule integral (A <sup>2</sup> s) (L/R = 5ms)	Packaging [pcs]	Weight [g]
1	63	004110426	004110431	004110435	15	2.720	3.520	1	750
	80	004110427	004110432	004110436	17	4.000	5.500		
	100	004110428	004110433	004110437	20	6.500	9.000		
	125	004110429	004110434	004110438	23	11.000	15.000		
	160	004110410	004110414	004110420	35	19.400	28.640		
2	200	004110430	004110415	004110421	42	40.000	60.000	1	1050
	250	004110413	004110417	004110423	46	85.260	117.400		
3	315	004110425	004110419	004110424	54	166.800	221.900	1	1360

picture 1

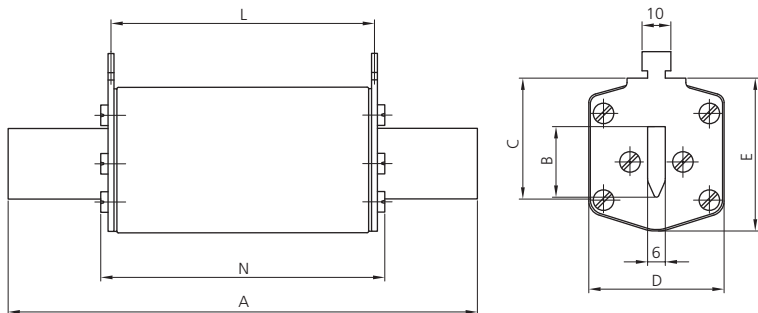

Size	dimensions [mm]						
	A	B	C	D	E	L	N
1	194	24	40	46	53	124	129
2	209	30	48	54	61	124	129
3	209	37	60	64	82	124	129

picture 2

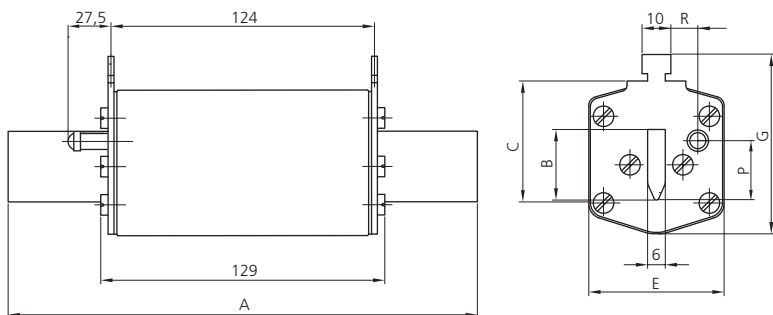

Size	dimensions [mm]							
	A	B	C	E	G	P	R	
1	194	24	40	46	61,5	20,5	13,7	
2	209	30	48	54	71	27,3	16,2	
3	209	37	60	64	82	35,6	17,0	



picture 3

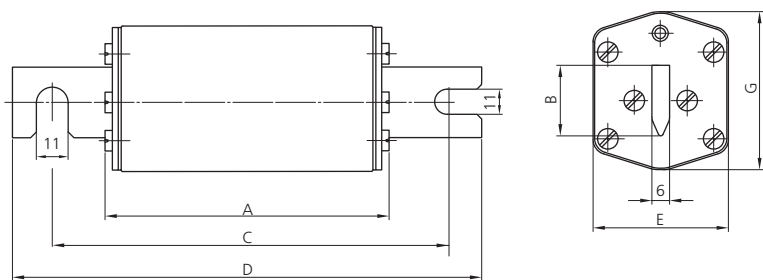

Size	dimensions [mm]					
	A	B	C	D	E	G
1	129	24	170	200	46	50
2	129	30	170	200	54	59
3	129	37	170	200	64	70

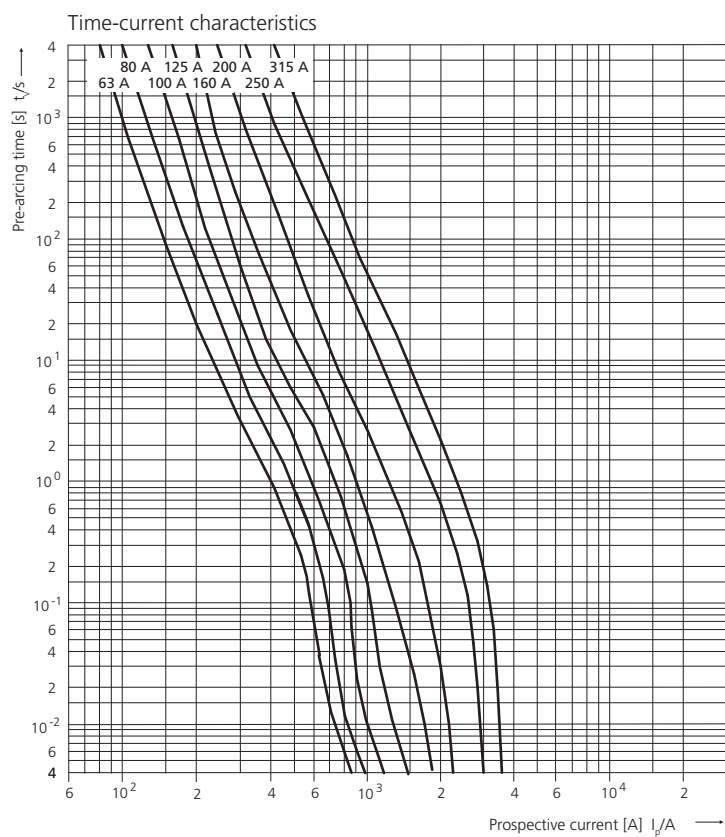

## Fuse base U1-3 DC 1000 V

Rated voltage $U_n$	1000 V d.c.
Rated current $I_n$	250 A, 400 A, 630 A
Insulation class	C-VDE0110
Standards	EN 60269, IEC 60269, DIN VDE 0636, DIN 43620, DIN 43623

Type	$I_n$ [A]	Code No.	Mechanical fuse monitor	Packaging [pcs]	Weight [g]
U1-1/1200/H	250	004122027	without	1	550
U1-1/1200/H/K	250	004122028	with		600
U2-1/1200/H	400	004122029	without		930
U2-1/1200/H/K	400	004122030	with		1000
U3-1/1200	630	004122031	without		1200
U3-1/1200/K	630	004122032	with		1250

Type	dimensions [mm]								
	A	B	C	D	E	F	G	G	I
U1-1/1200/H	56	232	140	25	37	84,5	96	17,5	M10
U2-1/1200/H	64	257	140	30	37	100	103	17,5	M10
U3-1/1200	68	270	140	40	38	103	-	25	M12

