

# FUSE-LINKS

D type fuse-links are used to protect electric, signal and control networks. I/t characteristics of type fuse-links comply with the following standards: IEC 60269 -1, DIN VDE 0636/301 and CEE 16.

CEE 16 standard regulates two types of characteristics:

- quick characteristics, in ETI the so-called DZ and
- time-lag, in ETI the so-called TDZ.

VDE 0603/301 and IEC 60269 -1 regulates the gG characteristics (protection in the whole range of the breaking capacity of the fuse).

Because their breaking characteristics are completely in accordance with CEE 16 requirements for slow characteristics, they can also be labeled as TDZ.

## Technical data:

Rated voltage $U_N$	500 V (DC 400V, AC 500 V)
Rated current $I_N$	DI, DII 2 - 25 A, DIII 32 - 63 A DIV 80 - 100 A, DV 125 - 200 A
Breaking capacity at 1, $1U_N$	50 kA ~ $\cos\varphi = 0,2$ 8kA ~ $T=15ms$
Fusing characteristics	gL - gG, TDZ, DZ
Insulating class	C - VDE 0110
Standards	DIN EN 60269-1 (VDE 0636 Teil 10) DIN EN 60269-3 (VDE 0636 Teil 30) DIN VDE 0636-301 IEC 60269-1 IEC 60269-3 EN 60269-1 EN 60269-3 CEE 16

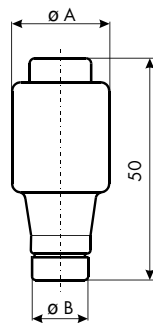
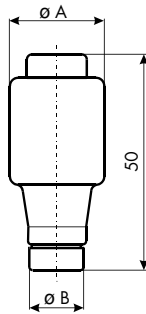
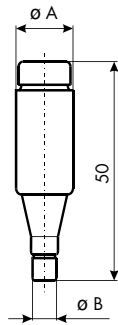

## DI for fuse base E 16

$I_N$ (A)	colour	code No. DZ	code No. gG, gL, TDZ	weight (g)	packaging (pcs)	dimension øA øB	
2	pink	2311101	2311401	12	10/500	13,2	6
4	brown	2311102	2311402	12	10/500	13,2	6
6	green	2311103	2311403	12	10/500	13,2	6
10	red	2311104	2311404	13	10/500	13,2	8
16	gray	2311105	2311405	14	10/500	13,2	10
20	blue	2311106	2311406	15	10/500	13,2	12
25	yellow	2311107	2311407	16	10/500	13,2	14

## DII for fuse base E 27

$I_N$ (A)	colour	code No. DZ	code No. gG, gL, TDZ	weight (g)	packaging (pcs)	dimension øA øB	
2	pink	2312101	2312401	27	5/500	21,5	6
4	brown	2312102	2312402	27	5/500	21,5	6
6	green	2312103	2312403	27	5/500	21,5	6
10	red	2312104	2312404	27	5/500	21,5	8
13	black		2311409	27	5/500	21,5	8
16	gray	2312105	2312405	28	5/500	21,5	10
20	blue	2312106	2312406	29	5/500	21,5	12
25	yellow	2312107	2312407	30	5/500	21,5	14

## DIII for fuse base E 33

$I_N$ (A)	colour	code No. DZ	code No. gG, gL, TDZ	weight (g)	packaging (pcs)	dimension øA øB	
32	black		2313404	48	5/500	27	16
35	black	2313101	2313401	48	5/500	27	16
40	black		2313405	48	5/500	27	16
50	white	2313102	2313402	49	5/500	27	18
63	copper	2313103	2313403	52	5/500	27	20

## DIV for fuse base R1 1/4"

$I_N(A)$	colour	code No.	code No.	weight	packaging	dimension	
		DZ	gG, gL, TDZ		(pcs)	$\varnothing A$	$\varnothing B$
80	silver	2314101	2314401	105	3/48	33	5
100	red	2314102	2314402	110	3/48	33	7

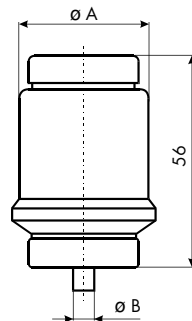

## DV for fuse base R 2"

$I_N(A)$	colour	code No.	code No.	weight	packaging	dimension	
		DZ	gG, gL, TDZ	(g)	(pcs)	$\varnothing A$	$\varnothing B$
125	yellow	2315101*	2315401*	185	10/60	46	5
160	copper	2315102*	2315402*	210	10/60	46	7
200	blue	2315103*	2315403*	215	10/60	46	9

\* special order

